





ModelY installation instructions

Tool

Product picture

Wrench	8mm Sleeve	Rocker	8mm Wrench
			



Installation instructions



1. Unscrew the support column, break off the guard plate, pull out the plug-in and remove the guard plate

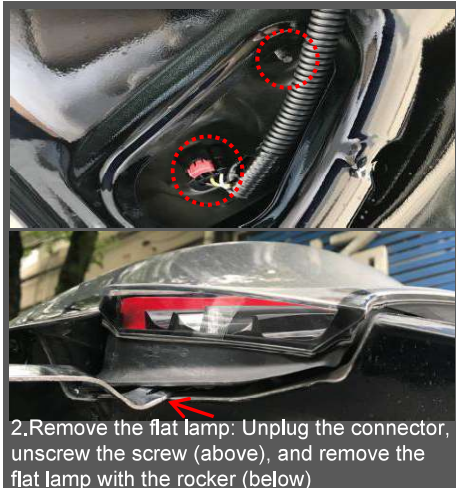

2. Remove the flat lamp: Unplug the connector, unscrew the screw (above), and remove the flat lamp with the rocker (below)

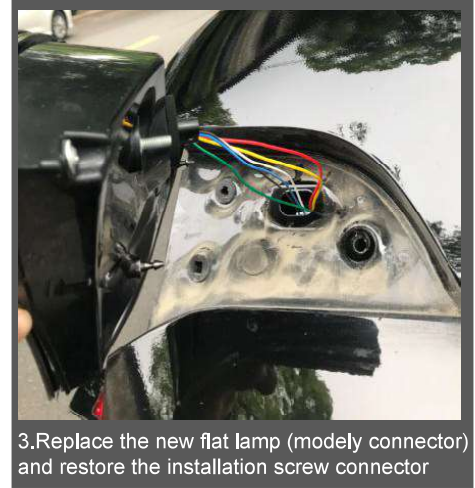

3. Replace the new flat lamp (modely connector) and restore the installation screw connector

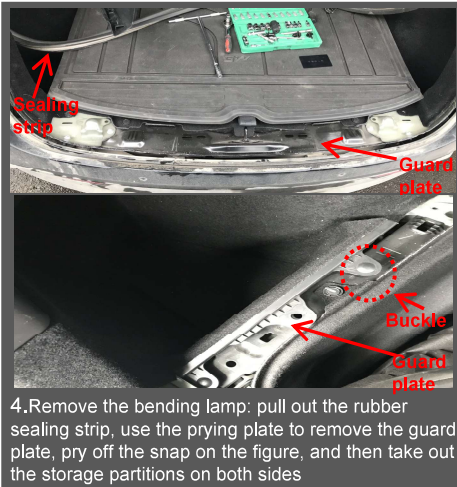

4. Remove the bending lamp: pull out the rubber sealing strip, use the prying plate to remove the guard plate, pry off the snap on the figure, and then take out the storage partitions on both sides

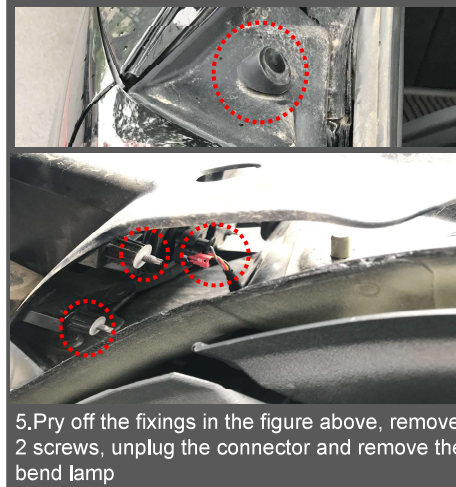

5. Pry off the fixings in the figure above, remove 2 screws, unplug the connector and remove the bend lamp



6. Use the prying plate to remove the set screw and then take out the bending lamp



7. Replace the new bend lamp and restore the installation screws and connectors

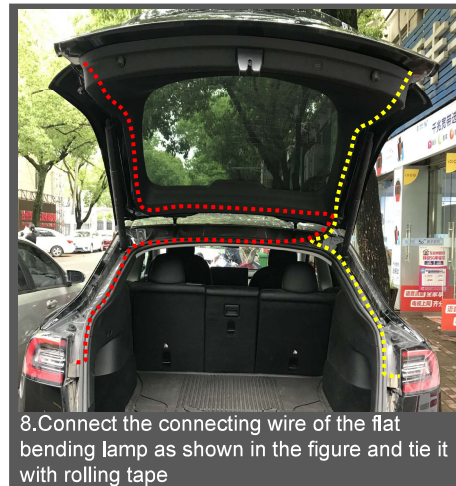

8. Connect the connecting wire of the flat bending lamp as shown in the figure and tie it with rolling tape

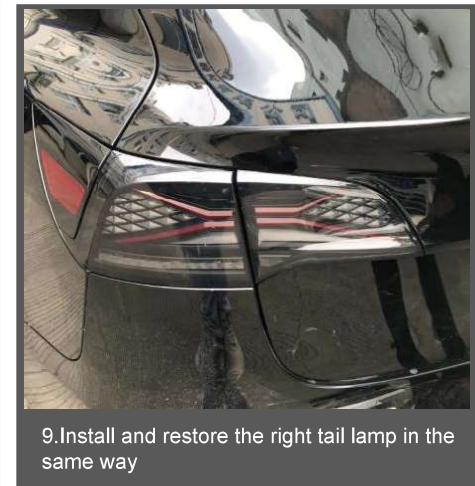

9. Install and restore the right tail lamp in the same way

Model3 installation instructions

Tool

Product picture

Wrench	8mm Sleeve	Rocker
		



Installation instructions

